

UC 300 Rolamento esférico com fixação por parafusos
Serviço Pesado

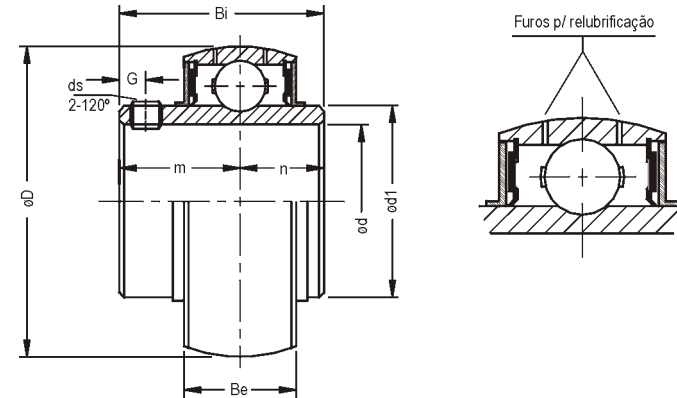

Ø eixo mm pol	Rolamento	Dimensão nominal (mm)							ds (mm) (UNF)	Cargas (Kgf)		Peso (Kg)
		D	d1	Bi	n	m	Be	G		dinâmica Cr	estática Cor	
25 1	UC 305 V22 UC 305-16 V22	62,0	35,5	38,0	15,0	23,0	21,0	6,0	M6x1 1/4-28	2280	1170	0,35
30 1-3/16	UC 306 V22 UC 306-19 V22	72,0	44,5	43,0	17,0	26,0	24,0	6,0	M6x1 1/4-28	2760	1550	0,55
1-1/4 35 1-7/16	UC 307-20 V22 UC 307 V22 UC 307-23 V22	80,0	49,0	48,0	19,0	29,0	25,0	8,0	M8x1 5/16-24	3420	1960	0,80
1-1/2 40	UC 308-24 V22 UC 308 V22	90,0	56,5	52,0	19,0	33,0	28,0	10,0	M10x1,25 3/8-24	4140	2450	1,00
1-11/16 1-3/4 45	UC 309-27 V22 UC 309-28 V22 UC 309 V22	100,0	62,0	57,0	22,0	35,0	30,0	10,0	M10x1,25 3/8-24	5410	3250	1,30
1-7/8 1-15/16 50	UC 310-30 V22 UC 310-31 V22 UC 310 V22	110,0	69,0	61,0	22,0	39,0	32,0	12,0	M12x1,25 7/16-20	6300	3860	1,70
2 55 2-3/16	UC 311-32 V22 UC 311 V22 UC 311-35 V22	120,0	75,0	66,0	25,0	41,0	34,0	12,0	M12x1,25 7/16-20	7300	4570	1,95
2-1/4 60 2-7/16	UC 312-36 V22 UC 312 V22 UC 312-39 V22	130,0	81,0	71,0	26,0	45,0	36,0	12,0	M12x1,25 7/16-20	8330	5290	2,60
2-1/2 65	UC 313-40 V22 UC 313 V22	140,0	87,5	75,0	30,0	45,0	38,0	12,0	M12x1,25 7/16-20	9580	6170	3,25
70	UC 314 V22	150,0	94,0	78,0	33,0	45,0	40,0	12,0	M12x1,25	10640	6940	3,95
2-15/16 75 3	UC 315-47 V22 UC 315 V22 UC 315-48 V22	160,0	100,5	82,0	32,0	50,0	42,0	14,0	M14x1,5 9/16-18	11570	7840	4,55
80	UC 316 V22	170,0	108,0	86,0	34,0	52,0	44,0	14,0	M14x1,5	12540	8830	5,55
85	UC 317 V22	180,0	114,0	96,0	40,0	56,0	46,0	16,0	M16x1,5	13530	9850	6,95
3-7/16 3-1/2 90	UC 318-55 V22 UC 318-56 V22 UC 318 V22	190,0	120,0	96,0	40,0	56,0	48,0	16,0	M16x1,5	14590	11020	7,95
95 100 100	UC 319 V22 UC 319-100 V22 UC 320 V22	200,0	126,5	103,0	41,0	62,0	50,0	18,0	M16x1,5	15920	12450	8,90
3-15/16 4	UC 320-63 V22 UC 320-64 V22	215,0	134,5	108,0	42,0	66,0	54,0	18,0	M18x1,5 3/4-16	17510	14290	11,10
110	UC 322 V22	240,0	151,7	117,0	46,0	71,0	59,0	18,0	M18x1,5	20900	18200	14,30
120	UC 324 V22	260,0	165,2	126,0	51,0	75,0	63,0	18,0	M18x1,5	21100	18800	18,50
130	UC 326 V22	280,0	178,3	135,0	54,0	81,0	67,0	20,0	M20x1,5	23300	21800	23,00
140	UC 328V22	300,0	190,4	145,0	59,0	86,0	72,0	20,0	M20x1,5	23300	21800	28,50