

S UCT200 { SE  
S YT200 { S

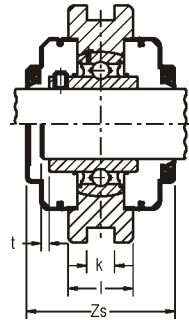

C UCT200 { CE  
C YT200 { C

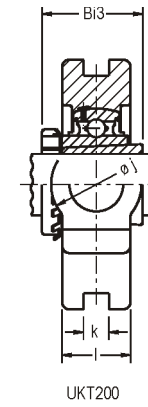
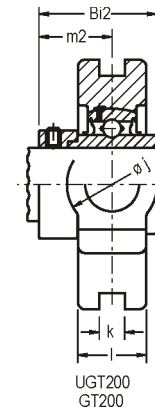
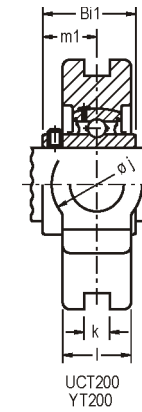
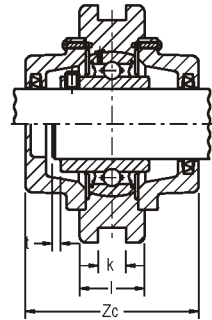

Ø eixo mm pol	Caixa	Dimensão nominal (mm)															
		o	g	p	q	s	b	k	e	a	w	l	j	h	t	Zs	Zc
12 1/2 15 5/8 17 3/4 20 7/8	T 204	16	10	51	32	19	51	12,0	76,0	89	94	21	32	61	2	51	62
15/16 25 1	T 205	16	10	51	32	19	51	12,0	76,0	89	97	24	32	62	2	57	70
1-1/16 1-1/8 30 1-3/16 1-1/4	T 206	16	10	56	37	22	57	12,0	89,0	102	113	28	37	70	2	62	75
1-1/4 1-5/16 1-3/8 35 1-7/16	T 207	16	13	64	37	22	64	12,0	89,0	102	129	30	37	78	3	72	80
1-1/2 40	T 208	19	16	83	49	29	83	16,0	102,0	114	144	33	49	88	3	82	90
1-9/16 1-5/8 1-11/16 1-3/4 45	T 209	19	16	83	49	29	83	16,0	102,0	117	144	35	49	87	3	82	95
1-13/16 1-7/8 1-15/16 50 2	T 210	19	16	83	49	29	86	16,0	102,0	117	149	37	49	90	3	87	100
2 2-1/8 55 2-3/16	T 211	25	19	102	64	35	95	22,0	130,0	146	171	38	64	106	4	92	100

UCT2 YT2	Peso (Kg)			D	UC 200 / Y 200		Rolamentos		UK 200		
	CUCT2 C(E) CYT2 C(E)	UGT2 GT2	UKT2		Bi1 m1	UG 200 / G 200 Bi2 m2	Ø Eixo	Bucha	Bi3		
0,80	1,10	0,80	-	47,0	31,0	18,3	43,5	26,5	-	-	-
0,80	1,20	0,90	0,90	52,0	34,0	19,7	44,3	26,9	3/4 20	HE2305 H2305	35,0
1,30	1,90	1,40	1,40	62,0	38,1	22,2	48,3	30,1	7/8 15/16 25 1	HS2306 HA2306 H2306 HE2306	38,0
1,70	2,50	1,80	1,70	72,0	42,9	25,4	51,1	32,3	1-1/8 30 1-3/16	HS2307 H2307 HA2307	43,0
2,20	3,20	2,40	2,30	80,0	49,2	30,2	56,3	34,9	1-1/4 1-5/16 1-3/8 35	HE2308 HA2308 HS2308 H2308	46,0
2,40	3,50	2,60	2,40	85,0	49,2	30,2	56,3	34,9	1-7/16 1-1/2 40 1-5/8	HA2309 HE2309 H2309 HS2309	50,0
2,50	3,80	2,70	2,60	90,0	51,6	32,6	62,7	38,1	1-11/16 1-3/4 45	HA2310 HE2310 H2310	55,0
4,20	5,80	4,50	4,20	100,0	55,6	33,4	71,3	43,6	1-7/8 1-15/16 50 2	HS2311 HA2311 H2311 HE2311	59,0

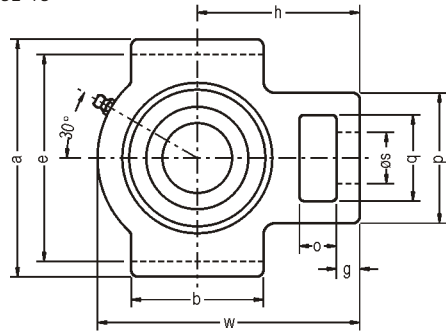

S UCT200 { SE  
S YT200 { S

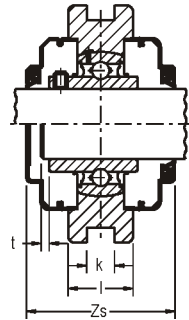

C UCT200 { CE  
C YT200 { C

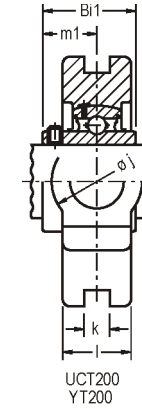
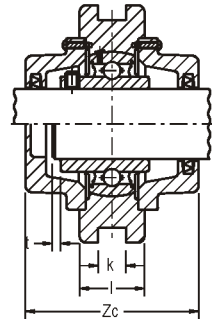

UCT200  
YT200

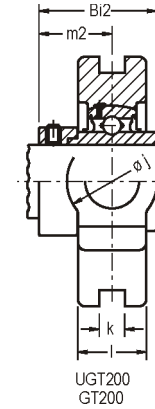

UGT200  
GT200

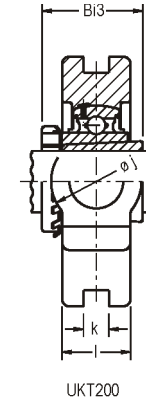

UKT200

Ø eixo mm pol	Caixa	Dimensão nominal (mm)															
		o	g	p	q	s	b	k	e	a	w	l	j	h	t	Zs	Zc
2-1/4 60 2-3/8 2-7/16	T 212	32	19	102	64	35	102	22,0	130,0	146	194	42	68	119	4	102	115
2-1/2 65	T 213	32	21	111	70	41	121	26,0	151,0	167	224	44	70	137	4	-	120
65 2-11/16 2-3/4 70	T 214	32	21	111	70	41	121	26,0	151,0	167	224	46	70	137	4	-	135
2-15/16 75 3	T 215	32	21	111	70	41	121	26,0	151,0	167	232	48	70	140	4	-	135
80 3-3/16	T 216	32	21	111	70	41	121	26,0	165,0	184	235	51	70	140	4	-	145
3-1/4 85	T 217	38	29	124	73	48	157	30,0	173,0	198	260	54	73	162	5	-	155
3-1/2 90	T 218	36	25	132	85	46	150	26,0	192,0	216	272	55	90	160	4	-	150

UCT2 YT2	Peso (Kg)			D	Rolamentos		Ø Eixo	UK 200 Bucha	Bi3		
	UCT2 C(E) CYT2 C(E)	UGT2 GT2	UKT2		UC 200 / Y 200 Bi1 / m1	UG 200 / G 200 Bi2 / m2					
5,10	7,90	5,40	5,00	110,0	65,1	39,7	77,7	46,8	2-1/8 55	HS2312 H2312	62,0
6,60	10,30	7,20	6,60	120,0	65,1	39,7	85,7	51,6	2-3/16 2-1/4 60 2-3/8	HA2313 HE2313 H2313 HS2313	65,0
7,10	9,90	7,70	-	125,0	74,6	44,4	85,7	51,6	-	-	-
7,20	11,40	7,80	7,60	130,0	77,8	44,5	92,1	54,8	2-1/2 65	HE2315 H2315	73,0
8,30	13,30	8,60	8,80	140,0	82,6	49,3	95,2	57,9	2-3/4 70	HE2316 H2316	78,0
10,40	16,20	-	10,80	150,0	85,7	51,6	-	-	75 3	H2317 HE2317	82,0
12,90	20,20	12,10	13,10	160,0	96,0	56,3	69,5	46,5	80	H2318	86,0